

PARK CITY ICE ARENA

PARK CITY ICE ARENA MEZZANINE RECONSTRUCTION PROJECT PROJECT # PAR.010.18

**LOCATED AT:
600 GILMOR WAY
PARK CITY, UTAH**

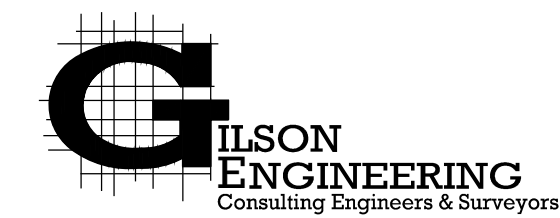

12401 SOUTH 450 EAST BUILDING C, UNIT 2, DRAPER, UT 84020
PHONE: (801) 571-9414 FAX: (801) 571-9449

REVISIONS:

△ ADDENDUM #1 8-02-18

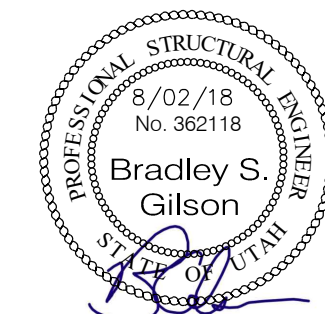

PARK CITY ICE ARENA MEZZANINE RECONSTRUCTION PROJECT

PAR.010

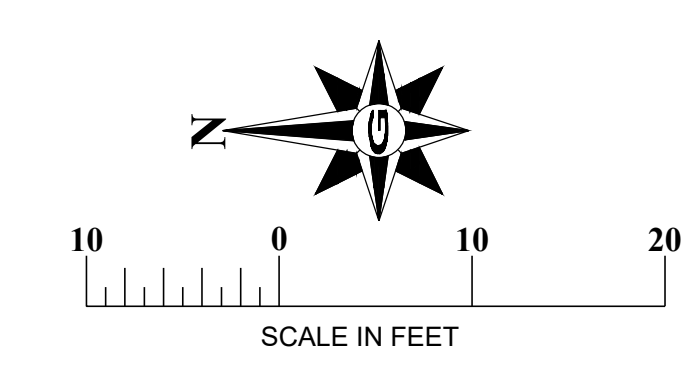

GILSON ENGINEERING
 Consulting Engineers & Surveyors
 12401 SOUTH 450 EAST BUILDING C, UNIT 2, DRAAPER, UT 84020
 PHONE: (801) 971-1414 FAX: (801) 971-1449

PROFESSIONAL SEAL
 BRADLEY S. GILSON
 LICENSE No. 362118
 STATE OF UTAH

GRADING & DRAINAGE CONSTRUCTION KEY NOTES

- 1 EXISTING CONCRETE AND MINIMUM 4" OF SUB-BASE TO BE REMOVED
- 2 EDGE OF EXISTING CONCRETE.
- 3 INSTALL NEW CONCRETE, BASE COURSE AND SEALANT PER DETAIL A ON THIS SHEET
- 4 CONSTRUCT ISOLATION JOINT/WATERPROOFING AT EDGE OF EXISTING CONCRETE (LOCKER ROOM AREA) PER DETAIL THIS SHEET.
- 5 EXISTING CONCRETE SURFACE OVER METAL DECKING AREA TO REMAIN, PROTECT IN PLACE. NO MECHANICAL EQUIPMENT USED FOR CONSTRUCTION MAY BE PLACED ON THIS AREA. DAMAGE TO THIS AREA SHALL BE REPAIRED AND/OR REPLACED TO THE SATISFACTION OF THE OWNER AND AT CONTRACTORS SOLE COST.
- 6 INSTALL ISOLATION JOINT AROUND EXISTING COLUMNS PER DETAIL THIS SHEET.
- 7 ANY IRRIGATION LINES DAMAGED OR DESTROYED DURING CONSTRUCTION ACTIVITIES SHALL BE REPAIRED TO THE SATISFACTION OF THE OWNER.

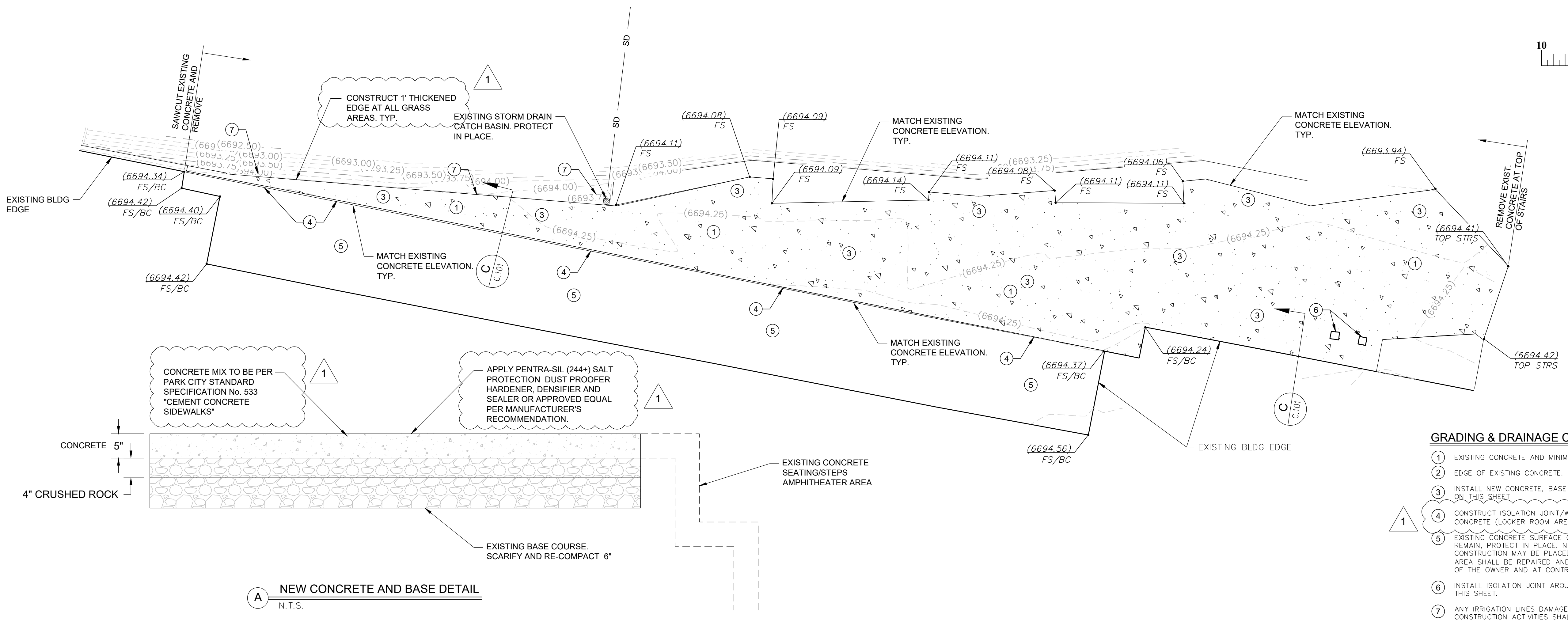

A NEW CONCRETE AND BASE DETAIL
 N.T.S.

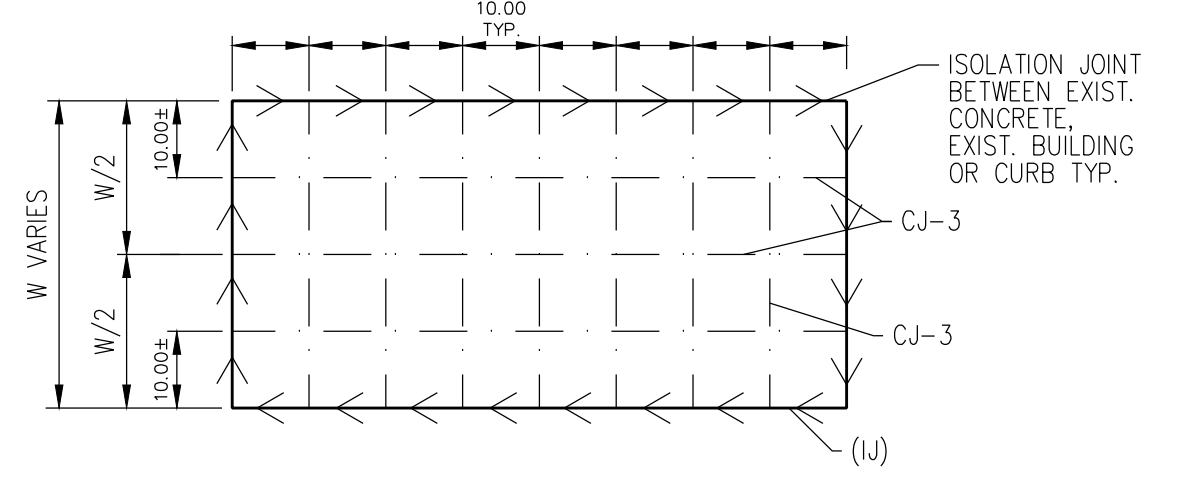
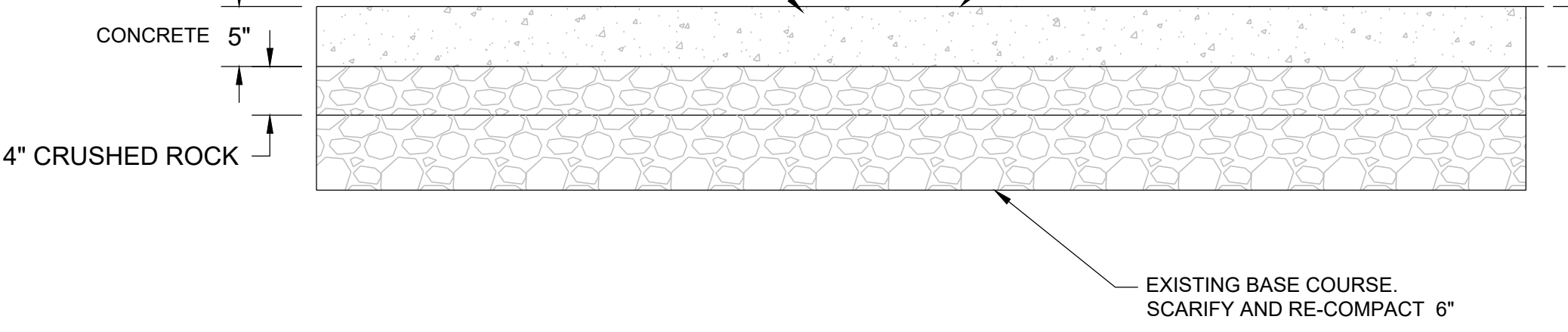

ZONE JOINT DETAIL
 N.T.S.

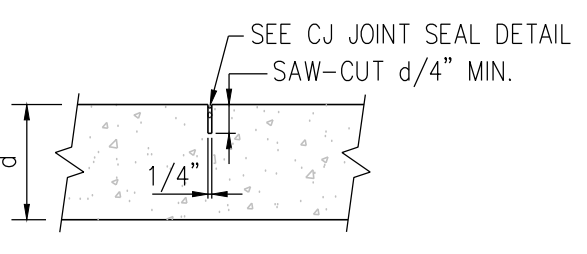

CONTROL JOINT (CJ-3)
 SCALE: N.T.S.

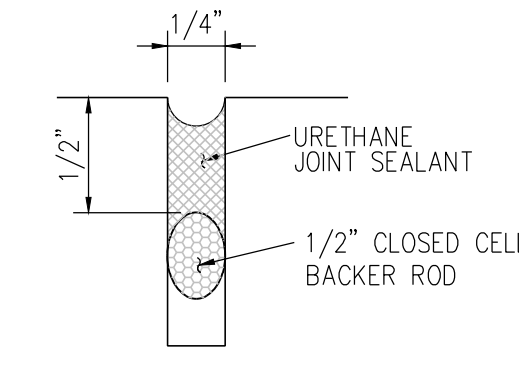

CJ JOINT SEAL DETAIL
 SCALE: N.T.S.

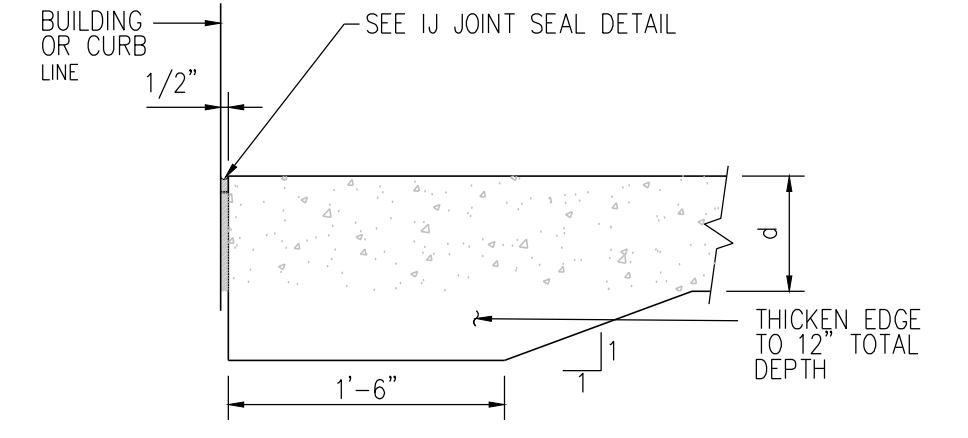

ISOLATION JOINT (IJ)
 SCALE: N.T.S.

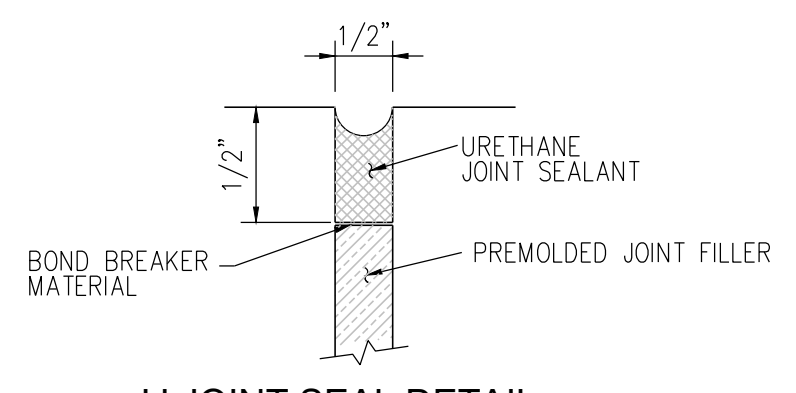

IJ JOINT SEAL DETAIL
 SCALE: N.T.S.

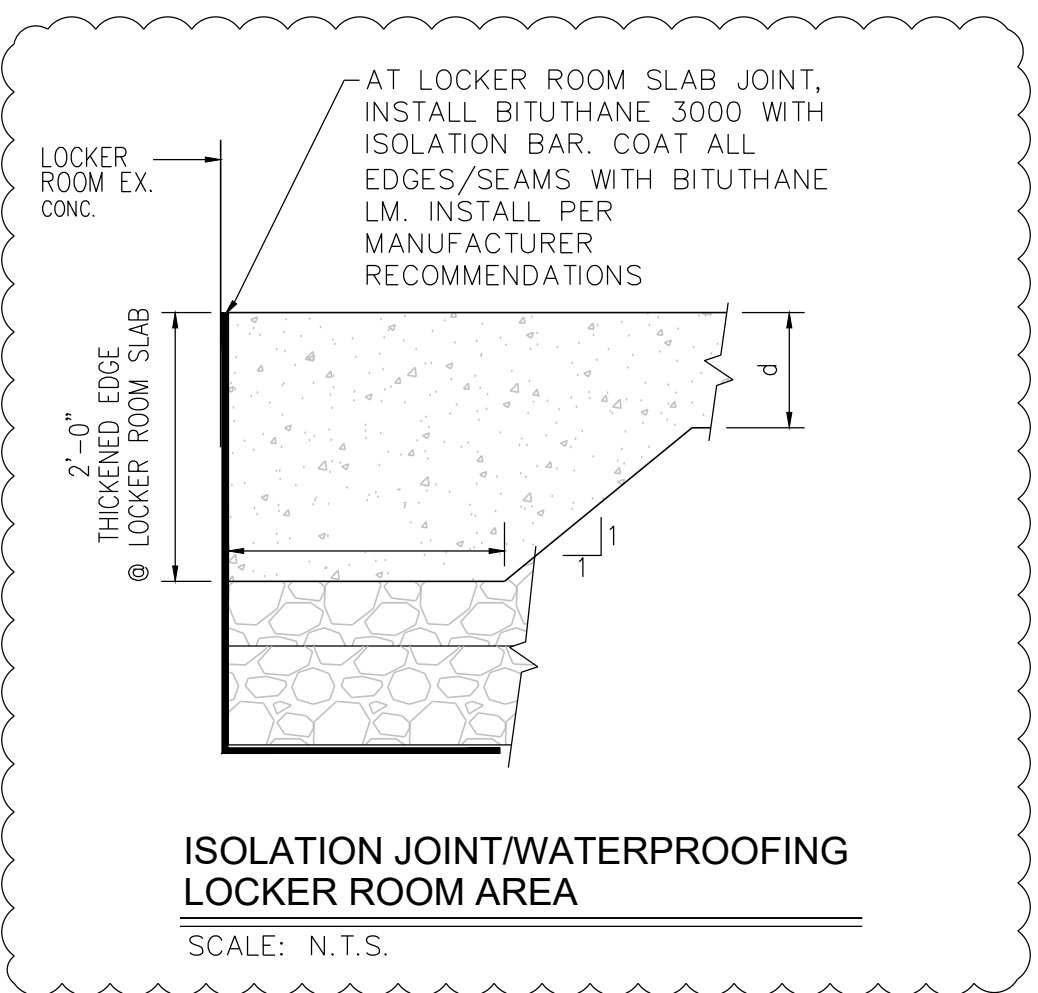
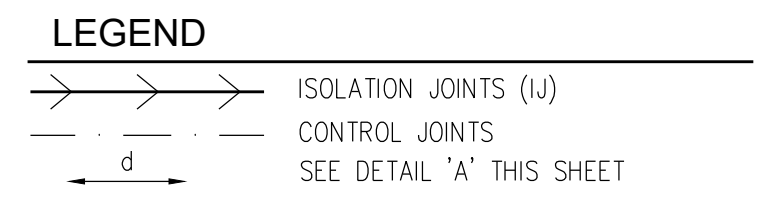

ISOLATION JOINT/WATERPROOFING LOCKER ROOM AREA
 SCALE: N.T.S.

B PORTLAND CEMENT CONCRETE PAVEMENT JOINT DETAILS

DISCLAIMER NOTE
 UTILITY LOCATIONS SHOWN HEREON ARE APPROXIMATE ONLY. IT SHALL BE THE CONTRACTOR'S RESPONSIBILITY TO DETERMINE THE EXACT HORIZONTAL AND VERTICAL LOCATION OF ALL EXISTING UNDERGROUND AND OVERHEAD UTILITIES PRIOR TO COMMENCING CONSTRUCTION. NO REPRESENTATION IS MADE THAT ALL EXISTING UTILITIES ARE SHOWN HEREON. THE ENGINEER ASSUMES NO RESPONSIBILITY FOR UTILITIES NOT SHOWN OR UTILITIES NOT SHOWN IN THEIR PROPER LOCATION.



GRADING AND DRAINAGE PLAN
 PARK CITY ICE ARENA MEZZANINE RECONSTRUCTION
 600 GILMOR WAY
 PARK CITY, UTAH

REVISIONS:
 PROJ. # **PAR.010**
C.101