

DATE: APRIL 19, 2009
 PROJECT NO.: 02-01-08
 FILE: PROJECT\T\PH4



TREASURE LOWELL AVENUE IMPROVEMENTS ON STREET PARKING ANALYSIS

FOR: MPE INC.

SHEET NO.: 051.0

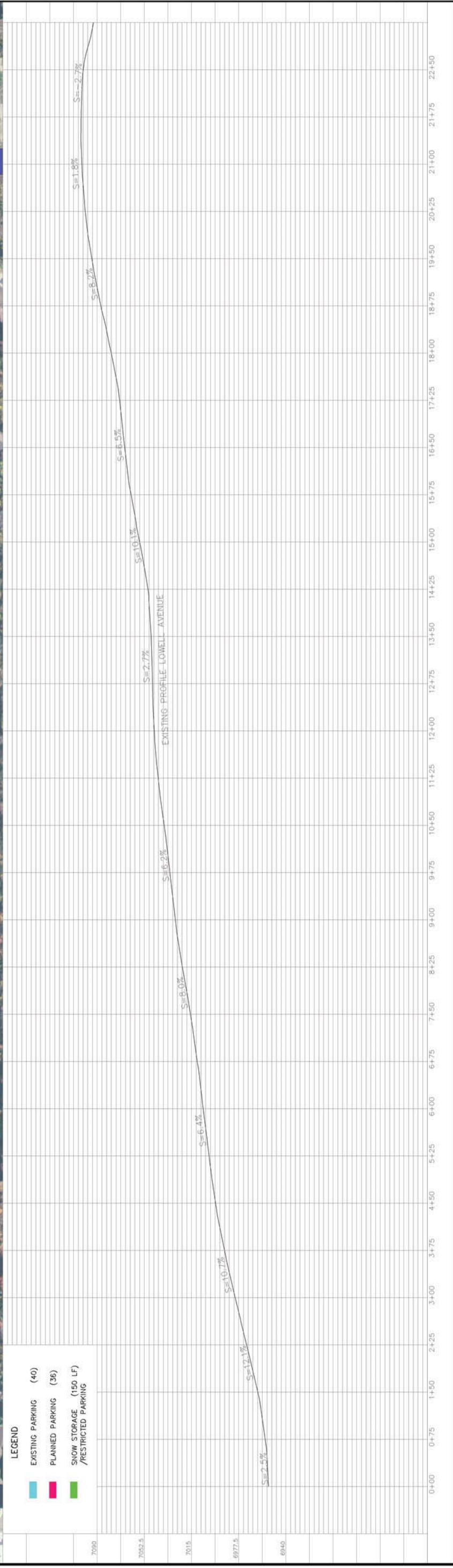

- LEGEND**
- █ EXISTING PARKING (40)
 - █ PLANNED PARKING (36)
 - █ SNOW STORAGE (150 LF) / RESTRICTED PARKING

DATE: APRIL 19, 2009
 PROJECT NO.: 01-08-02
 FILE: \PROJECT\THPH4



FOR: MPE INC.

TREASURE
 LOWELL AVENUE IMPROVEMENTS
 STA 0+00 - 6+40

SHEET NO: 092.0

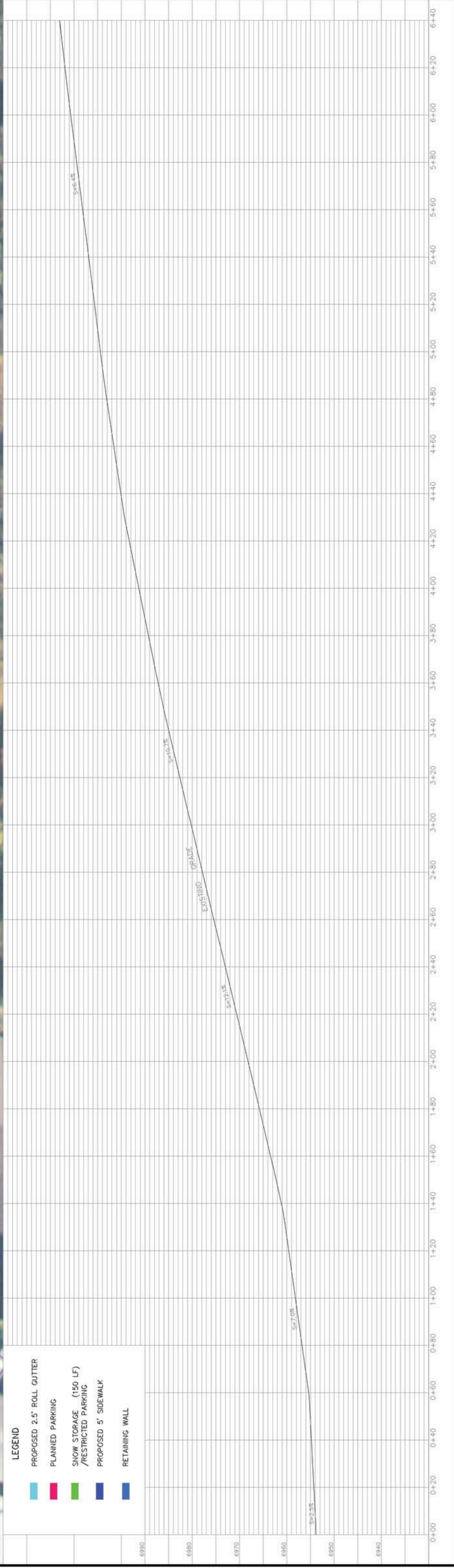
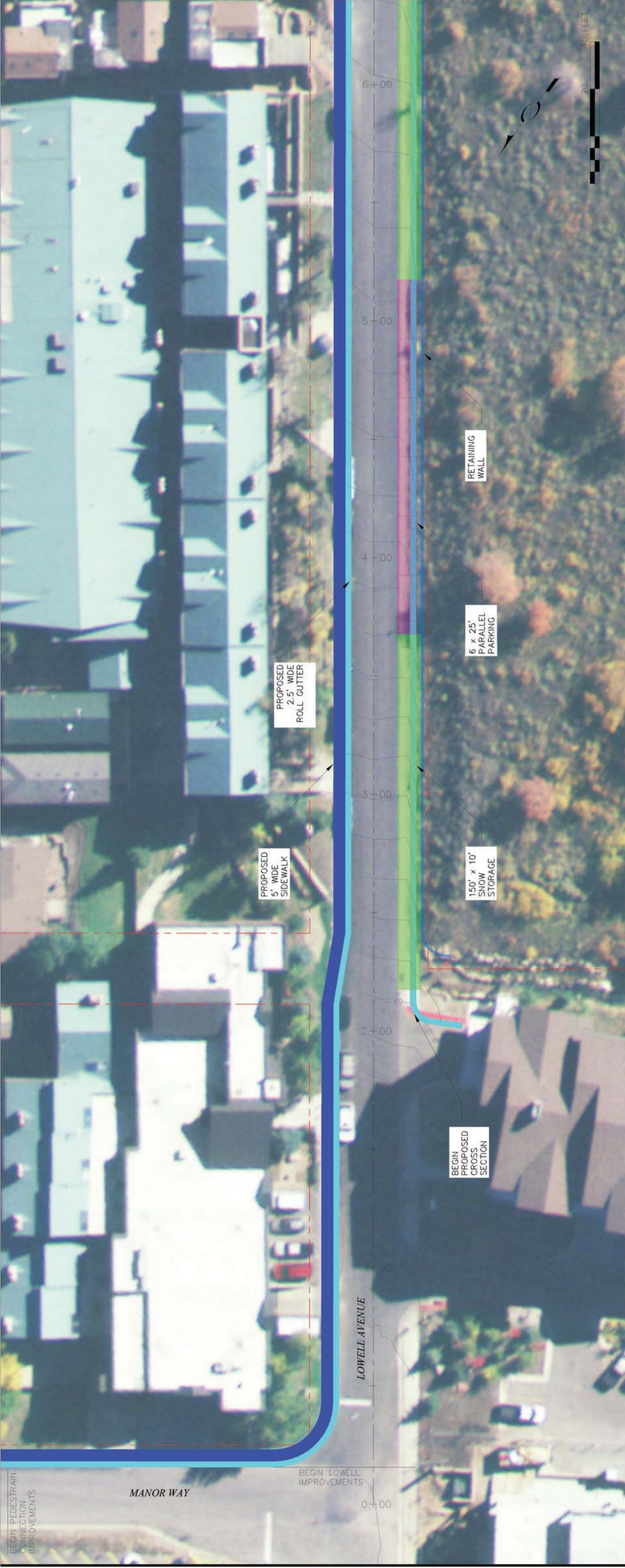

- LEGEND**
- PROPOSED 2.5' ROLL GUTTER
 - PLANNED PARKING
 - SNOW STORAGE (150 LF) / RESTRICTED PARKING
 - PROPOSED 5' SIDEWALK
 - RETAINING WALL

BEGIN PEDESTRIAN CONNECTION IMPROVEMENTS
 MANOR WAY
 BEGIN LOWELL IMPROVEMENTS

DATE: APRIL 19, 2009
 PROJECT NO.: 01-08-02
 FILE: VPROJECT\PH4



TREASURE
 LOWELL AVENUE IMPROVEMENTS
 STA 6+40-12+80

FOR: MPE INC.

SHEET NO: 093.0

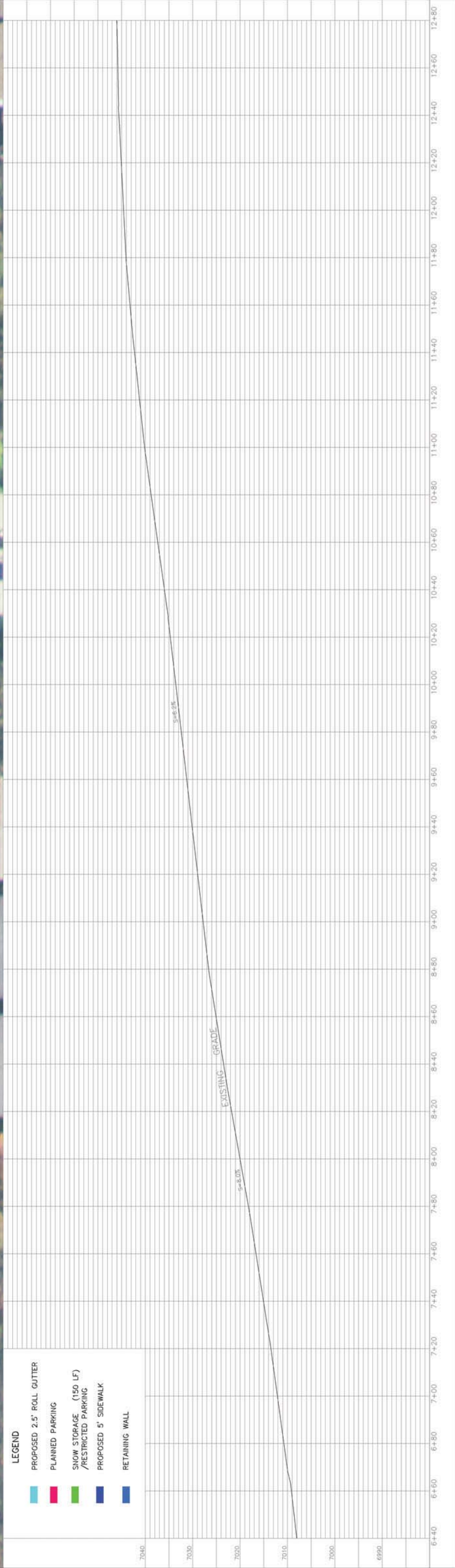

- LEGEND**
- PROPOSED 2.5' ROLL GUTTER
 - PLANNED PARKING
 - SNOW STORAGE (150 LF) / RESTRICTED PARKING
 - PROPOSED 5' SIDEWALK
 - RETAINING WALL

DATE: APRIL 19, 2009
 PROJECT NO.: 01-08-02
 FILE: \PROJECT\THPH4



TREASURE
 LOWELL AVENUE IMPROVEMENTS
 STA 12+80-19+20

FOR: MPE INC.

SHEET NO: 054.0

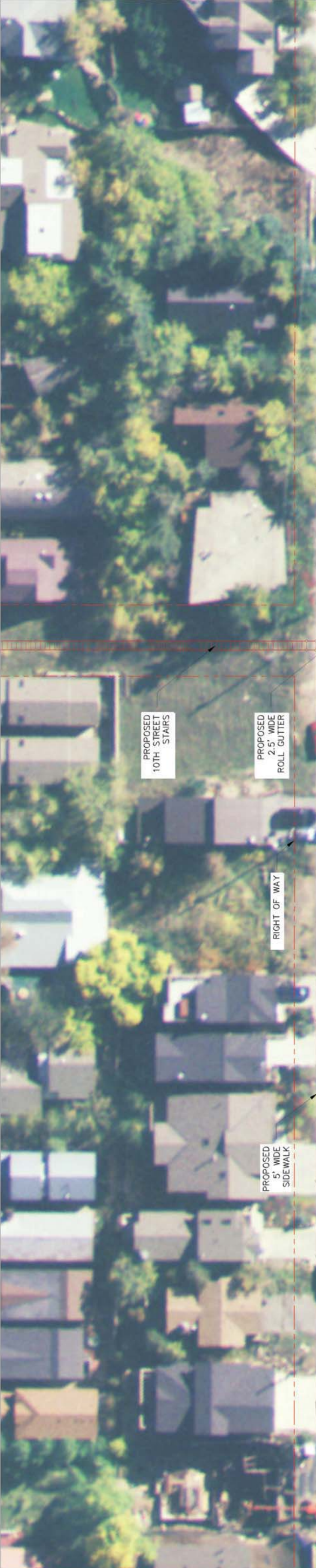

PROPOSED 10TH STREET STAIRS

PROPOSED 2.5' WIDE ROLL GUTTER

RIGHT OF WAY

PROPOSED 5' WIDE SIDEWALK

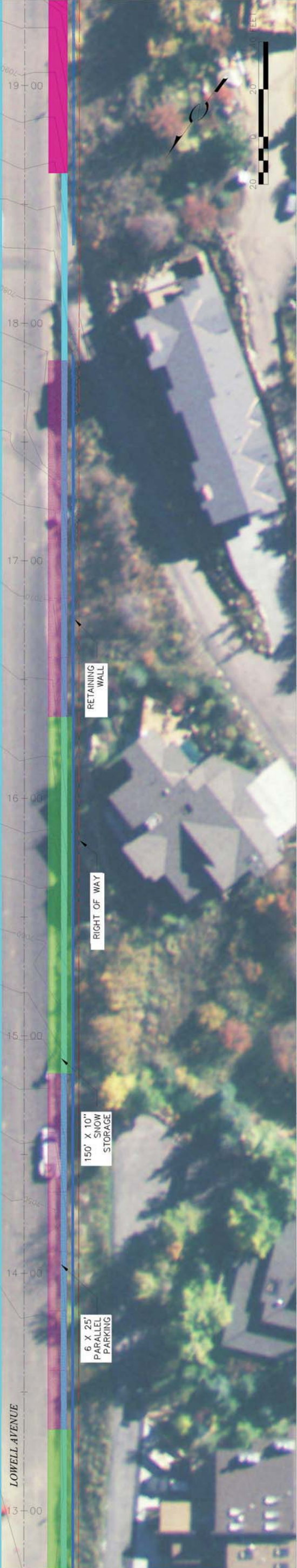

RETAINING WALL

RIGHT OF WAY

150' X 10" SNOW STORAGE

6' X 25' PARALLEL PARKING

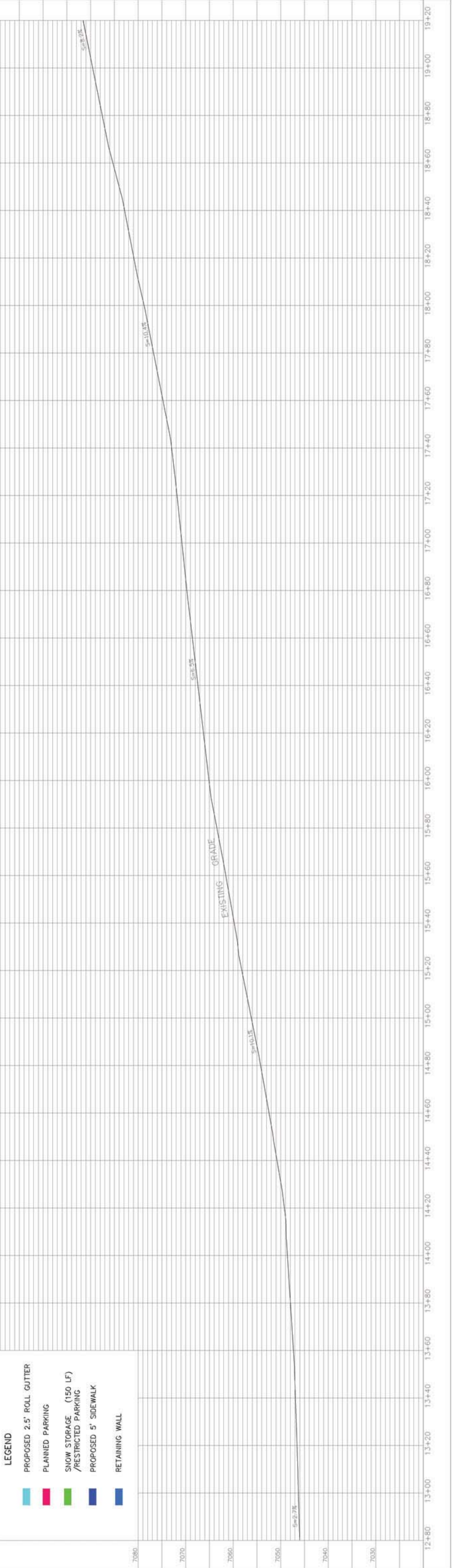

- LEGEND
- PROPOSED 2.5' ROLL GUTTER
 - PLANNED PARKING
 - SNOW STORAGE (150 LF) / RESTRICTED PARKING
 - PROPOSED 5' SIDEWALK
 - RETAINING WALL

DATE: APRIL 19, 2009
PROJECT NO.: 01-08-02
FILE: \PROJECT\THPH4



TREASURE
LOWELL AVENUE IMPROVEMENTS
STA 19+20-25+70
FOR: MPE INC.

SHEET NO: 055.0



- LEGEND
- PROPOSED 2.5' ROLL GUTTER
 - PLANNED PARKING
 - SNOW STORAGE (150 LF) /RESTRICTED PARKING
 - PROPOSED 5' SIDEWALK
 - RETAINING WALL

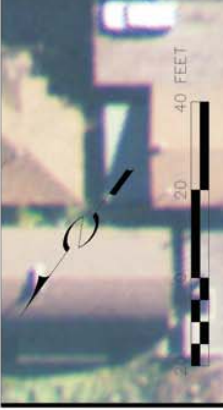
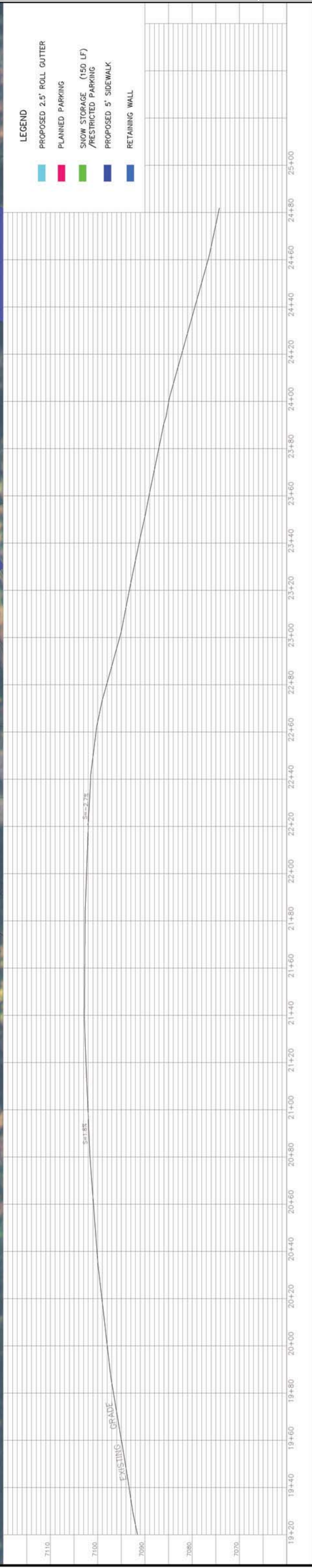

DATE: APRIL 19, 2009
 PROJECT NO.: 01-08-02
 FILE: PROJECTBTRPH4

MPE
 INCORPORATED

treasure
 PARK CITY, UTAH

ALTA ENGINEERING INC.
 CIVIL ENGINEERING • LAND PLANNING
 SURVEYING • PROJECT MANAGEMENT
 PO BOX 2864 PARK CITY, UTAH 84560-4356-8191

TREASURE
LOWELL AVENUE IMPROVEMENTS
TYPICAL ROAD CROSS SECTIONS

SHEET NO:
056.0

FOR: MPE INC.

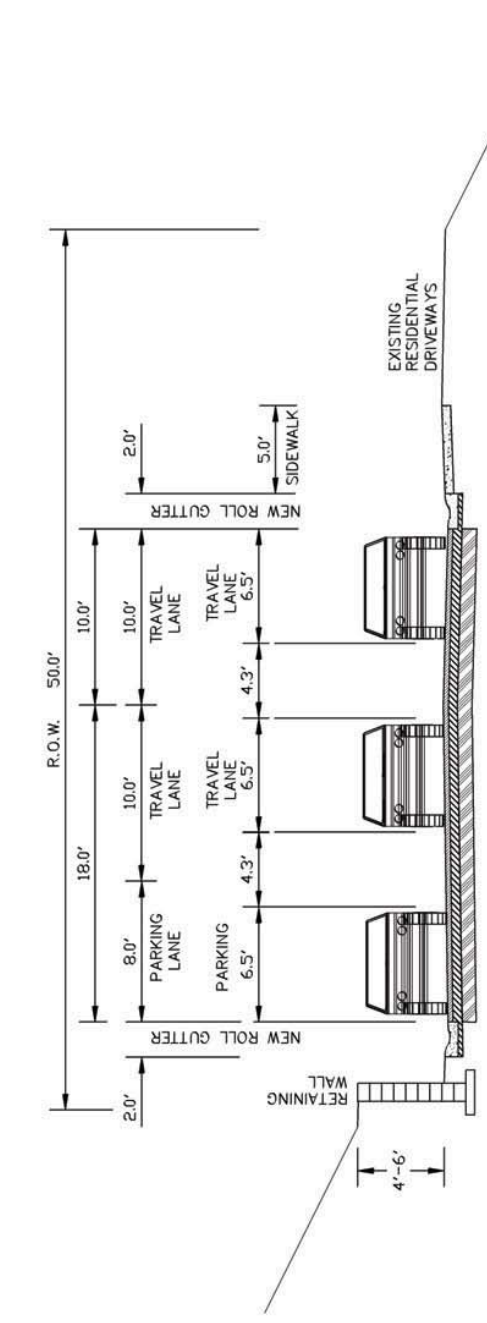

PROPOSED PEC ALTERNATE
 TYPICAL ROAD SECTION
 SCALE: 1"=5'

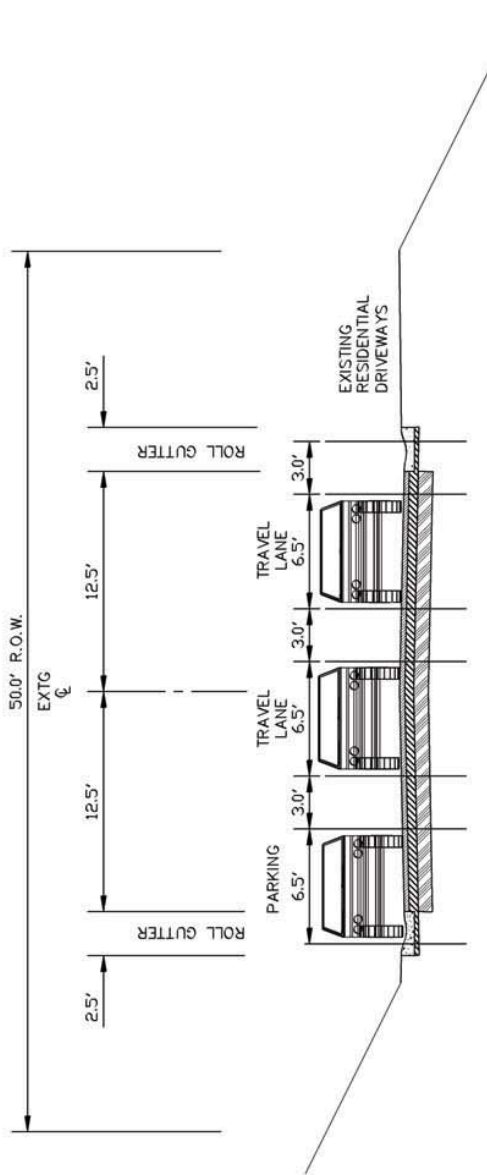

EXISTING LOWELL AVE.
 TYPICAL ROAD SECTION
 SCALE: 1"=5'

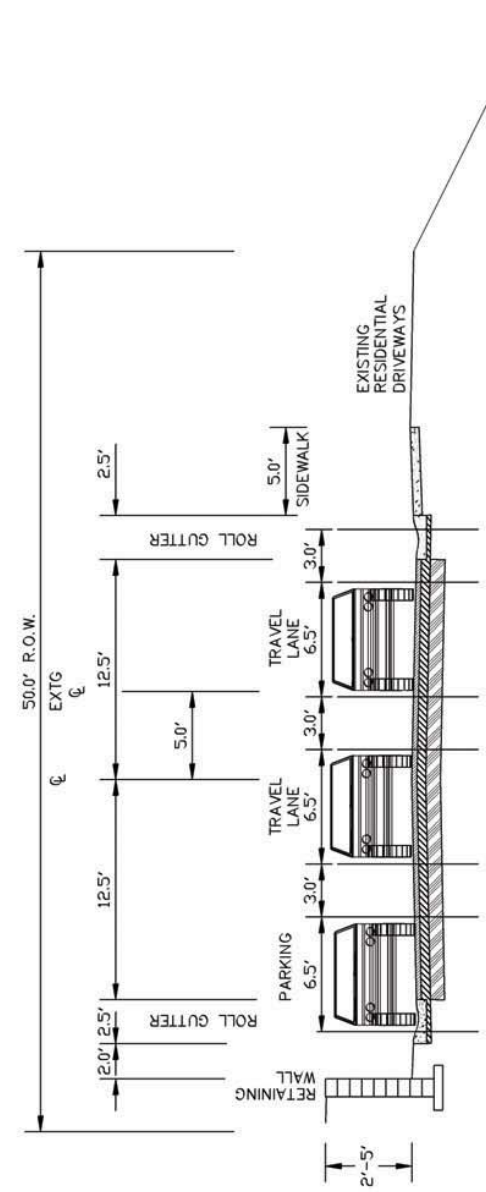

PROPOSED FEHR & PEERS W/ SIDEWALK
 TYPICAL ROAD SECTION
 SCALE: 1"=5'

DATE: APRIL 19, 2009
PROJECT NO.: 01-08-02
FILE: PROJECT\TPH4

MPE
INCORPORATED

treasure
PARK CITY, UTAH

ALTA
ENGINEERING
INC.
CIVIL ENGINEERING • LAND PLANNING
SURVEYING • PROJECT MANAGEMENT
PO BOX 2854 PARK CITY, UTAH 84080 435-649-8191

TREASURE
MANOR WAY - EMPIRE AVENUE
PROJECT ACCESS

FOR: MPE INC.

SHEET NO:
057.0

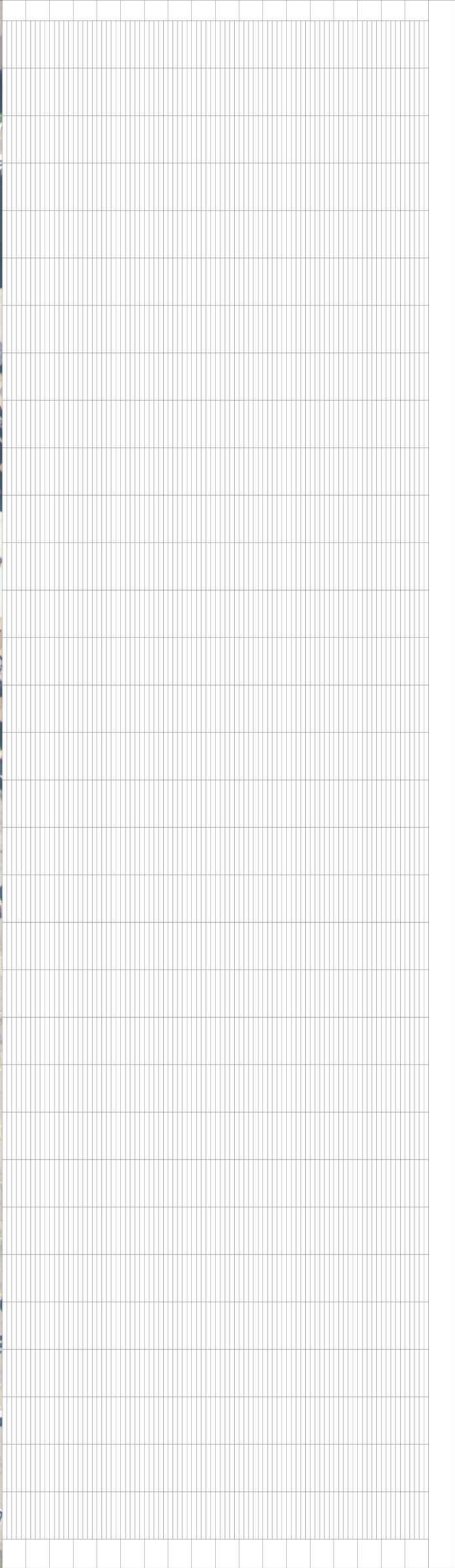

DATE: APRIL 19, 2009
PROJECT NO.: 01-08-02
FILE: PROJECT\TTPH4

MPE
INCORPORATED

treasure
PARK CITY, UTAH

ALTA
ENGINEERING
INC.
CIVIL ENGINEERING - LAND PLANNING
SURVEYING - PROJECT MANAGEMENT
PO BOX 2664 PARK CITY, UTAH 84080 435-649-8191

TREASURE
EMPIRE AVENUE - DEER VALLEY DRIVE
PROJECT ACCESS

FOR: MPE INC.

SHEET NO:
058.0

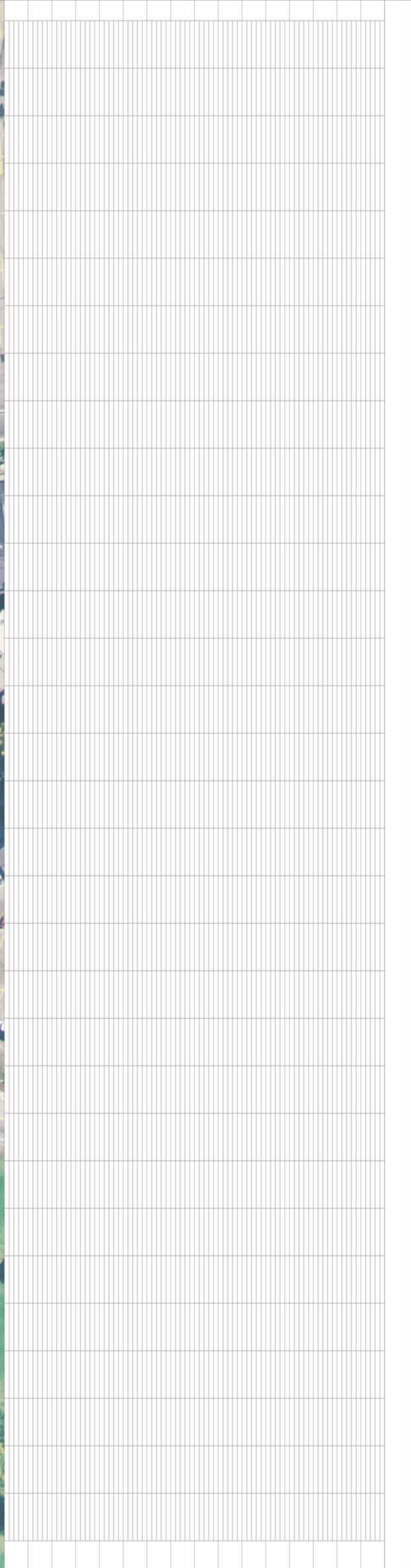

DATE: APRIL 19, 2009
PROJECT NO.: 02-01-08
FILE: PROJECTBTPH4



TREASURE LOWELL AVENUE IMPROVEMENTS EXISTING PARKING SURVEY

FOR:MPE INC.

SHEET NO: 059.0



DATE: APRIL 19, 2009
PROJECT NO.: 02-01-08
FILE: PROJECT81PH4

MPE
INCORPORATED

treasure
PARK CITY, UTAH

ALTA
ENGINEERING
INC.
CIVIL ENGINEERING - LAND PLANNING
SURVEYING - PROJECT MANAGEMENT
PO BOX 2864 PARK CITY, UTAH 84060 435-649-8191

FOR: MPE INC.

TREASURE
LOWELL AVENUE IMPROVEMENTS
1/4 MILE AREA ANALYSIS

SHEET NO:
0910

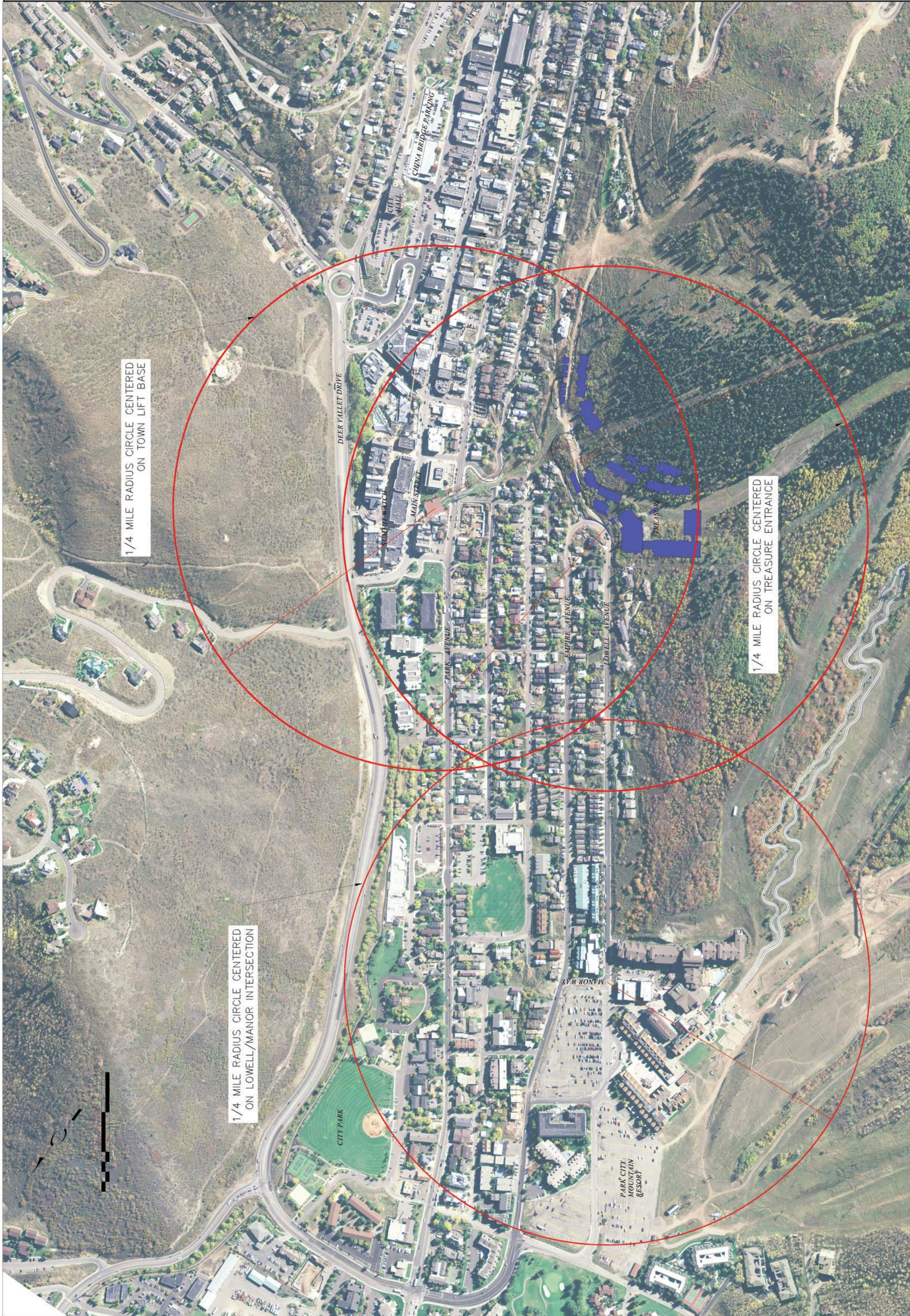

1/4 MILE RADIUS CIRCLE CENTERED
ON TOWN LIFT BASE

1/4 MILE RADIUS CIRCLE CENTERED
ON TREASURE ENTRANCE

1/4 MILE RADIUS CIRCLE CENTERED
ON LOWELL/MANOR INTERSECTION

